

# 2021 NEW CLUBHOUSE INFORMATION

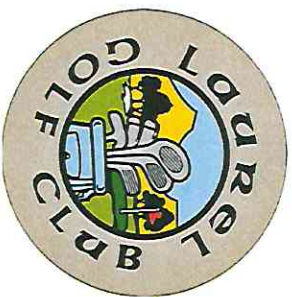

## KEY PROJECT GOALS

- Preserve LGC as a golf-focused club featuring the community's premier course
- Solve existing problems of falling infrastructure, which can no longer be adequately or financially maintained
- Maintain LGC as a golf club with basic supporting amenities—not a country club
- Create a practical, affordable clubhouse that will serve future generations of members for years to come



Site Plan Diagram

## NEW CLUBHOUSE DESIGN ELEMENTS

- The new clubhouse program areas are consistent with the current clubhouse, but designed to increase functionality of each space. This clubhouse is not adding any significant new program functions (i.e., banquet rooms, members-only areas, etc.). This approach maintains a focus on existing core functions, but increases their functionality and size to better accommodate club needs.
- The new clubhouse will generally be located where the existing clubhouse is now. However, this new design rotates slightly to take advantage of the site views looking down # 18. This also creates a better staging area for carts and bags, and increases the outdoor patio area.
- The floor plan layout is exceptionally efficient to minimize unnecessary circulation and eliminate unused spaces.
- The efficiency of pro shop, bag storage, and an outdoor staging area for carts will be considerably improved.
- The bar/dining room will feature more windows to maximize the extraordinary course views.
- The outdoor patio space will increase and become partially covered.

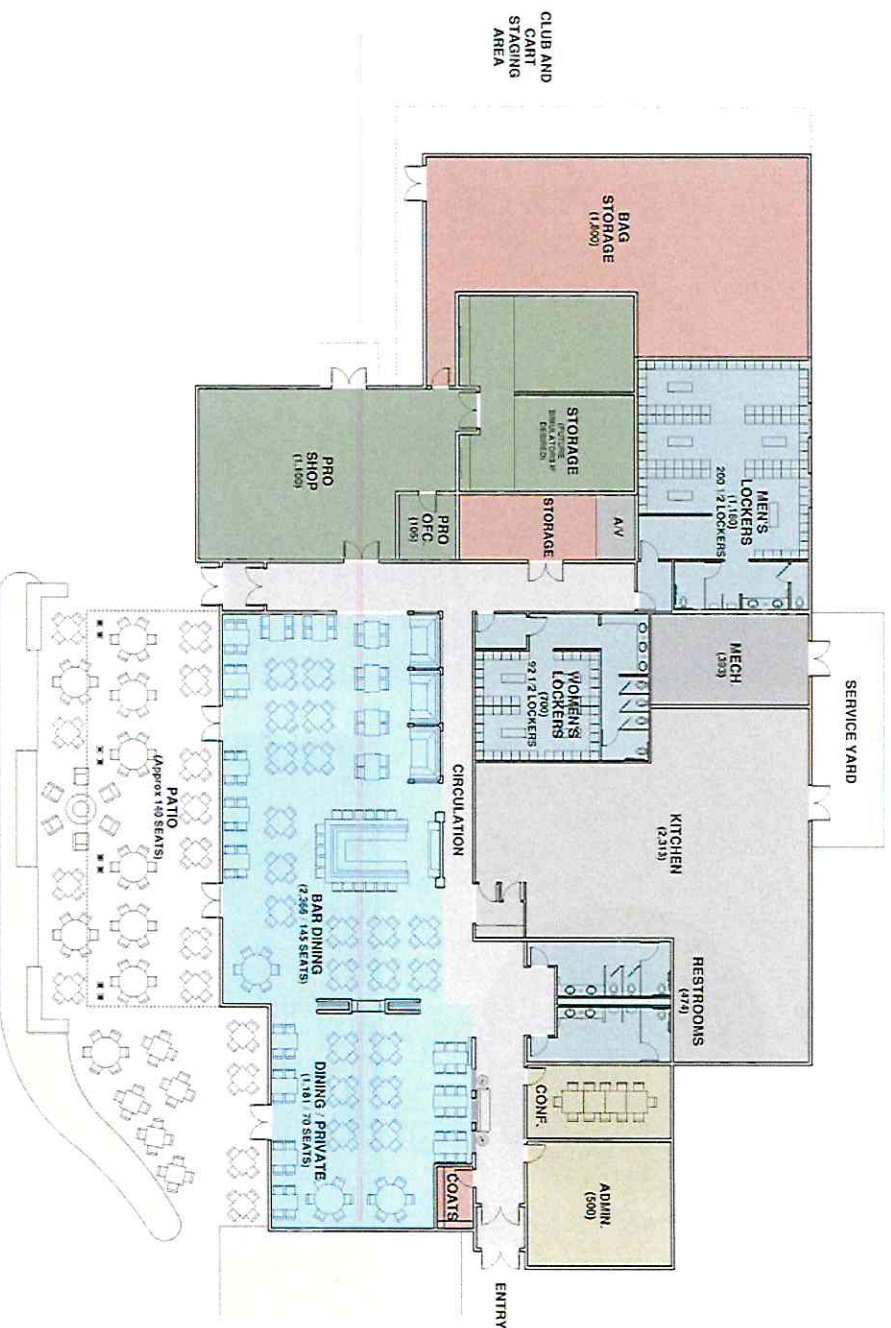

Floor Plan Diagram